

Crosby ELIMINATOR® Fittings

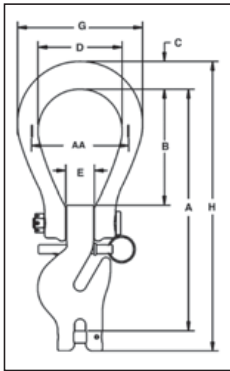

A-1361
Single Hook



The Crosby ELIMINATOR® combines selected features and functionality of a master link, connecting link, grab hook and adjuster legs to provide you with one fitting that is suitable for applications that require an adjustable length chain sling.

- Forged Alloy Steel - Quenched and Tempered.
- Innovative two piece design allows for maximum flexibility.
- Individually Proof Tested with certification.
- The Crosby ELIMINATOR®, if properly installed and locked, can be used for personnel lifting applications and meets the intent of OSHA Rule 1926.1431(g)(1)(i)(A) and 1926.1501(g)(4)(iv)(B).
- Suitable for use with Grade 100 and Grade 80 chain.
- Engineered to accommodate optional locking pins that can be inserted to “lock” the shortened chain legs into place.
- Fatigue rated at 1-1/2 times the Working Load Limit at 20,000 cycles.
- Use the A-1361 and A-1362 in combination to make 3 leg chain slings.
- Load pin assembly instructions on page 276.
- “Look for the Platinum Color - Crosby Grade 100 Alloy Products.”
- All sizes are **RFID EQUIPPED**.



A-1362
Single Hook

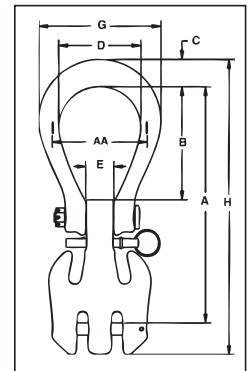

Crosby 8/10™



Fatigue Rated®



Chain & Accessories

A-1361 Crosby ELIMINATOR® Single Hook

Chain Size		Frame Size	Working Load Limit (t)*	A-1361 Stock No.	L-1361 Stock No.	Weight Each (kg)	Dimensions (mm)								S-4104N Replacement Latch Pin Stock No.
(in)	(mm)						A	B	C	D	E	G	H	AA	
1/4	7	2	2.0	1049797	1049802	1.76	208	99.0	22.9	76.2	23.9	89.0	112	248	1092983
5/16	8	2	2.6	1049804	1049809	1.76	208	99.0	22.9	76.2	23.9	89.0	112	248	1092983
3/8	10	3	4.0	1049813	1049818	2.94	255	122	29.5	88.9	28.7	102	132	306	1092992
1/2	13	4	6.8	1049822	1049827	6.12	327	152	41.4	105	33.3	127	162	395	1093001
5/8	16	5	10.3	1049831	1049836	10.9	388	175	49.8	121	41.4	152	188	472	1093010

* Proof tested at 2.5 times the Working Load Limit. Minimum Ultimate Load is 4 times the Working Load Limit.

A-1362 Crosby ELIMINATOR® Double Hook

Chain Size		Frame Size	Working Load Limit (t)*	A-1362 Stock No.	L-1362 Stock No.	Weight Each (kg)	Dimensions (mm)								S-4104N Replacement Latch Pin Stock No.
(in)	(mm)						A	B	C	D	E	G	H	AA	
1/4	7	2	3.9	1049859	1049913	2.13	208	99.0	22.9	76.2	23.9	89.0	112	257	1092983
5/16	8	2	5.0	1049868	1049922	2.13	208	99.0	22.9	76.2	23.9	89.0	112	257	1092983
3/8	10	3	8.0	1049877	1049931	3.67	255	122	29.5	88.9	28.7	102	132	319	1092992
1/2	13	4	13.6	1049886	1049940	7.84	327	152	41.4	105	33.3	127	162	413	1093001
5/8	16	5	20.5	1049895	1049949	14.3	388	175	49.8	121	41.4	152	188	491	1093010

* Proof tested at 2 times the Working Load Limit. Minimum Ultimate Load is 4 times the Working Load Limit.

Using Crosby ELIMINATOR® in 3 and 4 Leg Slings

See page 222-223 for basic chain sling components.

Spectrum 10® Chain Size		Master Link A-342 Stock No.	Master Link A-1342 Stock No.	Crosby ELIMINATOR® Single A-1361 Stock No.	Crosby ELIMINATOR® Double A-1362 Stock No.	Spectrum 10® Chain Size		Master Link A-342 Stock No.	Master Link A-1342 Stock No.	Crosby ELIMINATOR® Single A-1361 Stock No.	Crosby ELIMINATOR® Double A-1362 Stock No.
(in)	(mm)					(in)	(mm)				
1/4 (9/32)	7	1014285	1011412	1049797	1049859	1/4 (9/32)	7	1014285	1011412	–	1049859
5/16	8	1014319	1011421	1049804	1049868	5/16	8	1014319	1011421	–	1049868
3/8	10	1014331	1011430	1049813	1049877	3/8	10	1014331	1011430	–	1049877
1/2	13	1014348	1011449	1049822	1049886	1/2	13	1014348	1011449	–	1049886
5/8	16	1014365	1011458	1049831	1049895	5/8	16	1014365	1011458	–	1049895

Use one of either A-342 or A-1342 master link.
Use one of each when making three leg sling.

Use one of either A-342 or A-1342 master link.
Use two A-1362 fittings when making quad leg sling.