

Crosby® Grade 100 Clevis Grab Hooks

Fatigue Rated

"QT"
QUENCHED & TEMPERED

Crosby 8/10™ CE



Para Español: www.thecrosbygroup.com

SEE APPLICATION AND WARNING INFORMATION

On Page 258

A-1338



- Forged Alloy Steel - Quenched and Tempered.
- Innovative cradle design allows for 100% efficiency of Grade 100 chain.
- Individually Proof Tested to 2-1/2 times the Working Load Limit with certification.
- Each hook has a Product Identification Code (PIC) for material traceability, along with the size and the name Crosby & U.S.A. in raised letters.
- Suitable for use with Grade 100 and Grade 80 chain.
- The use of A-1338 Cradle Grab Hook will allow 100 percent of the chain sling capacity. When used to hook back to chain leg to form a choker, the angle of the choke must be 120 degrees or greater. When used as a chain shortener, minimize twist of chain and ensure chain is fully engaged in hook.
- Fatigue rated at 1-1/2 times the Working Load Limit at 20,000 cycles.
- "Look for the Platinum Color - Crosby Grade 100 Alloy Products."

L-1338

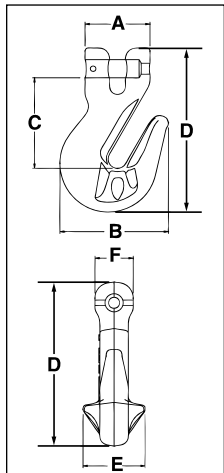

A-1338/L-1338 Cradle Grab Hook

Chain Size		Working Load Limit (t)*	A-1338 Stock No.	L-1338 Stock No.	Weight Each (kg)	Dimensions (mm)						S-4338 Replacement Latch Kit Stock No.
(in.)	(mm)					A	B	C	D	E	F	
1/4	7	2.0	1049417	1049480	.20	43.7	64.5	55.9	98.5	38.1	22.4	1048426
5/16	8	2.6	1049426	1049489	.45	43.7	64.5	55.4	98.5	38.1	22.4	1048426
3/8	10	4.0	1049435	1049498	.82	47.0	78.5	65.5	119	46.5	27.7	1048435
1/2	13	6.8	1049444	1049507	1.78	60.7	97.3	83.3	149	57.2	36.1	1048444
5/8	16	10.3	1049453	1049516	3.18	67.8	115	97.8	179	74.5	44.5	1048453

* Ultimate Load is 4 times the Working Load Limit.

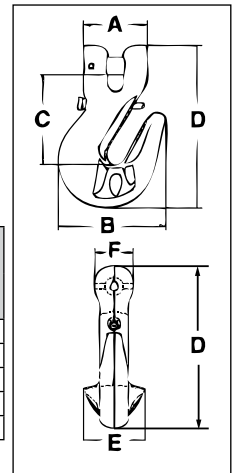

Chain & Accessories

Fatigue Rated

"QT"
QUENCHED & TEMPERED

Crosby 8/10™ CE

A-1358



- Forged Alloy Steel - Quenched and Tempered.
- Individually Proof Tested to 2-1/2 times the Working Load Limit with certification.
- Each hook has a Product Identification Code (PIC) for material traceability, along with the size and the name Crosby & U.S.A. in raised letters.
- Suitable for use with Grade 100 and Grade 80 chain.
- Fatigue rated at 1-1/2 times the Working Load Limit at 20,000 cycles.
- "Look for the Platinum Color - Crosby Grade 100 Alloy Products."

L-1358

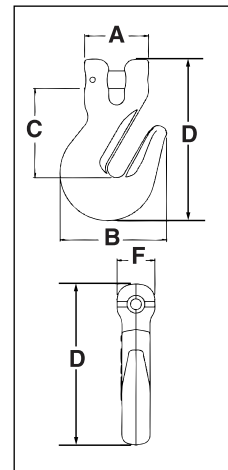

A-1358/L-1358 Grab Hook

Chain Size		Working Load Limit (t)*	A-1358 Stock No.	L-1358 Stock No.	Weight Each (kg)	Dimensions (mm)					S-4338 Replacement Latch Kit Stock No.
(in.)	(mm)					A	B	C	D	F	
1/4	7	2.0	1049610	1049605	.20	43.7	64.5	55.9	98.5	22.4	1048426
5/16	8	2.6	1049629	1049614	.45	43.7	64.5	55.4	98.5	22.4	1048426
3/8	10	4.0	1049638	1049623	.82	47.0	78.5	65.5	119	27.7	1048435
1/2	13	6.8	1049647	1049634	1.78	60.7	97.3	83.3	149	36.1	1048444
5/8	16	10.3	1049656	1049643	3.18	67.8	115	97.8	179	44.5	1048453

* Ultimate Load is 4 times the Working Load Limit.

