

Pear Shaped Links

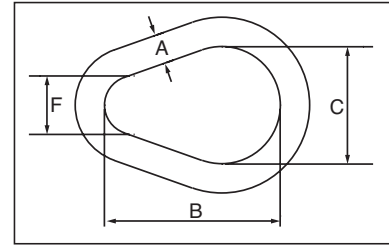

A-341
Alloy Pear Shaped Links

- Alloy Steel - Quenched and Tempered
- Individually Proof Tested at 2 times Working Load Limit with certification.
- Proof Test certification shipped with each link.
- Sizes 13mm, 16mm, 19mm, 22mm, 25mm, 32mm and 35mm are forged.



A-341 Alloy Pear Shaped Links

Stock Size (A) (mm)	A-341 Stock No	Working Load Limit		Weight Each (kg)	Dimensions (mm)		
		(t)*	(lb)		B	C	F
13	1013575	3.15	7000	.25	76.2	50.8	25.4
16	1013584	4.09	9000	.50	95.3	63.5	31.8
19	1013595	5.59	12300	.80	114	76.2	38.1
22	1013604	6.81	15000	1.28	133	88.9	44.5
25	1013613	11.0	24360	1.91	152	102	51.0
28	1013622	13.9	30600	2.83	171	114	57.0
32	1013631	16.4	36000	3.74	191	127	63.5
35	1013640	19.5	43000	5.10	210	140	70.0
†† 38	1013649	24.7	54300	6.46	229	152	76.0
†† 42	1013658	28.4	62600	8.39	248	165	82.5
†† 44	1013667	38.6	84900	10.2	267	178	89.0
†† 48	1013676	43.5	95800	13.2	286	191	95.5
†† 51	1013685	46.6	102600	15.4	305	203	102
†† 57	1013694	65.0	143100	21.8	343	229	114
†† 64	1013703	66.9	147300	29.9	381	254	127
†† 70	1013712	98.6	216900	39.9	419	279	140
†† 76	1013721	103	228000	52	457	305	152
†† 83	1013730	119	262200	66	495	330	165
†† 89	1013739	126	279000	82	533	356	178
†† 102	1013748	169	373000	123	610	406	203

*Based on single leg sling (in-line load), or resultant load on multiple legs with an included angle less than or equal to 120°. Minimum Ultimate load is 5 times the Working Load Limit. †† Welded Link.



G-341 / S-341
Weldless Sling Link

- Forged carbon steel - Quenched and Tempered.
- Self Colored or Hot Dip Galvanized.

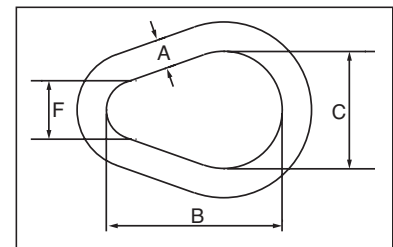

G-341 / S-341 Weldless Sling Links

Size (A) (mm)	Stock No.		Working Load Limit Single Pull (t.)*	Weight Each (kg)	Dimensions (mm)		
	G-341 Galv.	S-341 S.C.			B	C	F
10	1013897	1013904	.82	0.10	57.2	38.1	19.1
13	1013913	1013922	1.32	.25	76.2	50.8	25.4
16	1013931	1013940	1.91	.48	95.5	63.5	31.8
19	1013959	1013968	2.72	.85	114	76.2	38.1
22	1013977	1013986	3.76	1.25	133	88.9	44.5
25	1013995	1014002	4.90	1.97	152	102	51.0
32	1014011	1014020	7.60	3.45	197	127	63.5
35	1014039	1014048	9.30	5.13	210	140	70.0

*Ultimate Load is 6 times the Working Load Limit. Based on single leg sling (in-line load), or resultant load on multiple legs with an included angle less than or equal to 120°.