

Yoke Grade 8 Excavator Weld-on Hook BS EN 1677-1+2

The William Hackett Grade 8 forged lifting components are manufactured by YOKE from alloy steel in accordance with EN1677. All forged components are individually magnaflux crack detected after heat treatment, they are then individually proof load tested to 2.5 times working load limit in accordance with EN1677. Only components fully compliant with all aspects of EN1677 can be used in chain slings certified to EN818-4. The William Hackett Grade 8 lifting components are suitable for use in a temperature range of -40°C up to 200°C without reduction in working load limit.

USES

- Designed to be a permanent slinging attachment point for jibs and arms on mobile excavators

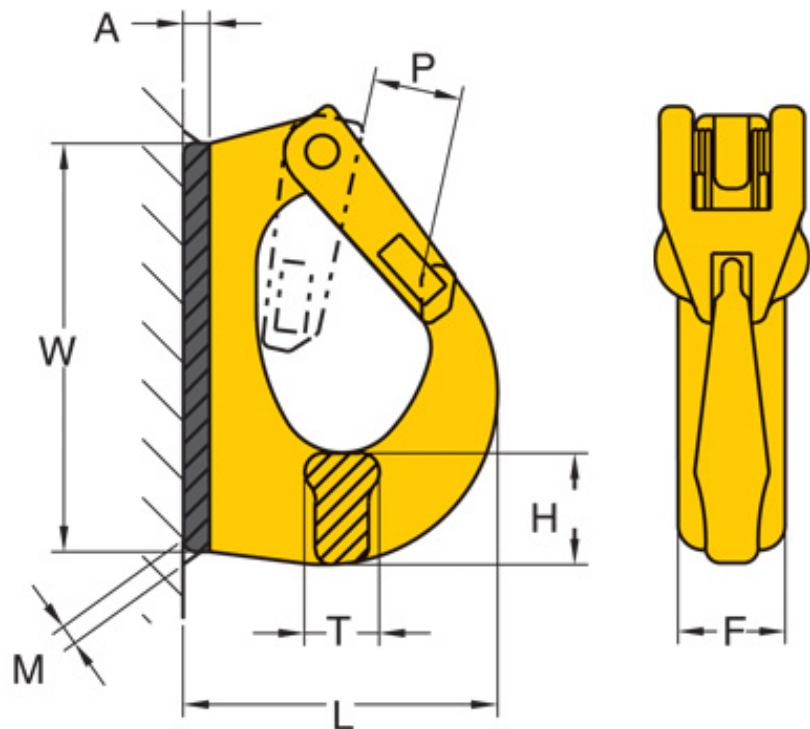

SPECIFICATIONS

Part Code	W.L.L tonnes	P mm	L mm	T mm	H mm	F mm	W mm	A mm	M mm	Box Quantity	Mass Kg
8-081-01	1.0	18	70	18	27	25	95	7	4	24	0.6
8-081-02	2.0	25	85	20	30	30	115	8	5	18	1.0
8-081-03	3.0	28	107	23	30	35	133	9	6	12	1.4
8-081-04	4.0	28	114	30	38	42	142	10	7	12	2.0
8-081-05	5.0	30	135	31	47	44	167	12	7	6	3.0
8-081-08	8.0	32	137	39	52	50	176	12	8	6	3.8
8-081-10	10.0	44	170	42	56	56	222	13	8	4	6.3

Click here to view video of Yoke Load Attachment Products

<http://www.yoke.net/video/en.asp>